

HRCW SERIES

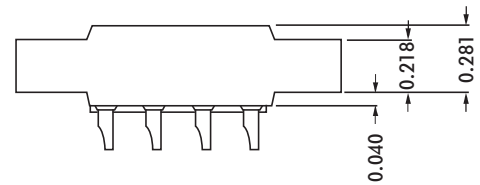

CONTACT DATA		CHASSIS MOUNTING DATA				
		CHASSIS THICKNESS	X-DIMENSION			
OPEN ENTRY	SOLDER CUP	1/16	.14	HRCW - 1	HRCW - 22	
		3/32	.11	HRCW - 31	HRCW - 32	
		1/8	.08		HRCW - 42	
	EYELET	1/16	.14	HRCW - 5	HRCW - 6	
		3/32	.11	HRCW - 35	HRCW - 36	
		1/8	.08		HRCW - 46	
	STRAIGHT	1/16	.14		HRCW - 24	
		3/32	.11			
		1/8	.08			
	CLOSED ENTRY	SOLDER CUP	1/16	.14	HRCW - 1K	HRCW - 22K
			3/32	.11	HRCW - 31K	HRCW - 32K
			1/8	.08		HRCW - 42K
EYELET		1/16	.14	HRCW - 5K	HRCW - 6K	
		3/32	.11	HRCW - 35K	HRCW - 36K	
		1/8	.08		HRCW - 46K	
STRAIGHT		1/16			HRCW - 24K	
		3/32				
		1/8				

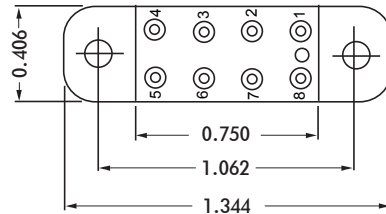
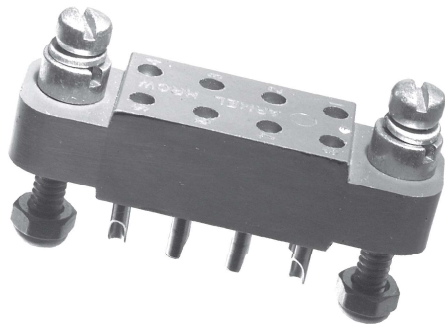
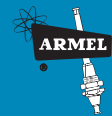
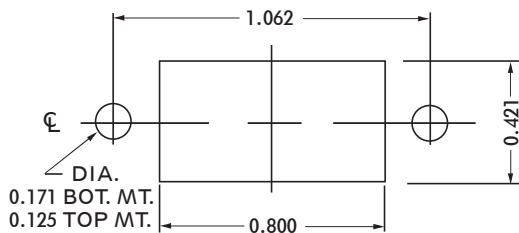

RECOMMENDED CHASSIS CUT-OUT

ELECTRICAL

Wire Size:

Solder Cup Type One #20 AWG
 Eyelet Type Two #20 AWG or
 Three #22 AWG

Current Rating 3 Amperes

Withstanding Voltage:

Contact to Contact Sea Level . . . 2700 VRMS Minimum
 Contact to Ground Sea Level . . . 2250 VRMS Minimum
 Contact to Contact 70,000 Ft. . . . 560 VRMS Minimum
 Contact to Ground 70,000 Ft. . . . 500 VRMS Minimum

MECHANICAL

Creepage Between Contacts 0.16 Minimum
 Air Space Between Contacts 0.11 Minimum
 Contacts to Accept 0.030 ± 0.001 DIA. Pins

Contacts:

Spring Temper Grade "A" Phosphor Bronze, or
 Heat Treated Beryllium Copper
 Gold Plated over Copper or Nickel Plate

Mounting Hardware:

Special Studs, Screws, Lockwashers, and Nuts

Insulation Material:

Choice of **MIL Approved** Thermosetting
 Insulations (See Page 45)

Temperature Ratings: -65°C to +125°C

Weight of Socket with Mountings: 0.27 oz.